



Tool Post Grinders

For Inner and Outer Diameter Grinding, Surface Preparation and Finishing

Electric Tool Post Grinders for 2" (51 mm) Wide x 48" (122 cm) Long Belts

Fixed Speed Models (for faster cutting)

MODEL 65750

7200 SFPM

MODEL 65751

6000 SFPM

- These models have a water-tight on/off switch and built-in ammeter measures motor load.

Variable Speed Models

MODEL 65752

220 Volt

MODEL 65753

440 Volt

- These models include a variable speed rate motor. A digital display shows the operating speed and can be adjusted via keypad to any desired belt speed, even when the tool is in operation. Display also shows load percentage on the motor itself.

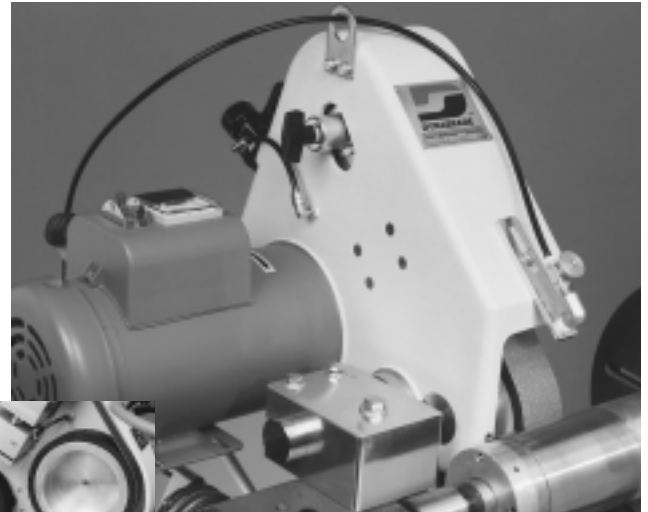

Ideal for use on steel, hard chrome, tungsten carbide, ceramics, thermal spray.

Drip-pan (included) catches and deflects stray coolant.

Features (All Models):

- Air-powered belt tensioning. Easily accessible belt-tracking and air belt-tensioning adjustments.
- Easy to dress contact wheel. 90 durometer fixed contact wheel (66619) is standard. Uses flexible diamond and other abrasive belts.
- Coolant nozzle with adjustable flow valve.
- Rigidly mounts to all standard lathes.

Model Number	Motor HP (W)	Motor RPM	Sound Level	Air Pressure PSI (Bars)	Max. SFPM (SMPM)	Voltage	Phase	Frequency	Weight Pound (kg)	Length Inch (mm)	Height Inch (mm)
65750	3.0 (2,237)	3,450	81 dB(A)	90 (6.2)	7,200 (2,187)	240	1	60 Hz	108 (49)	19 (483)	18 (457)
65751	3.0 (2,237)	2,850	81 dB(A)	90 (6.2)	6,000 (1,823)	240	1	50 Hz	108 (49)	19 (483)	18 (457)
65752	3.0 (2,237)	N/A	81 dB(A)	90 (6.2)	2,500-10,500 (762-3,200)	220	3	50-60 Hz	108 (49)	19 (483)	18 (457)
65753	3.0 (2,237)	N/A	81 dB(A)	90 (6.2)	2,500-10,500 (762-3,200)	440	3	50-60 Hz	108 (49)	19 (483)	18 (457)

Additional Specifications: Air Inlet Thread 1/4" NPT

Electric Tool Post Grinders for 2" (51 mm) Wide x 36" (915 mm) Long Belts

- Grind and polish metal, plastic, rubber, urethane, wood and composites.
- 4" (102 mm) dia. x 2" (51 mm) wide 90-durometer, standard smooth face, contact wheel (65338).
- Includes corrosion-resistant parts, coolant nozzle with adjustable flow valve and coolant drip pan.
- Water-tight on/off switch. Built-in ammeter measures load.
- Rigidly mounts to lathe compound for close tolerance work.

MODEL 64991

60 Hz/3,450 RPM

MODEL 64993

50 Hz/2,850 RPM

- Air-powered belt tensioning for quick and easy belt changes.

MODEL 65014

60 Hz/3,450 RPM

MODEL 65016

50 Hz/2,850 RPM

- These models feature a manual belt tensioning lever.

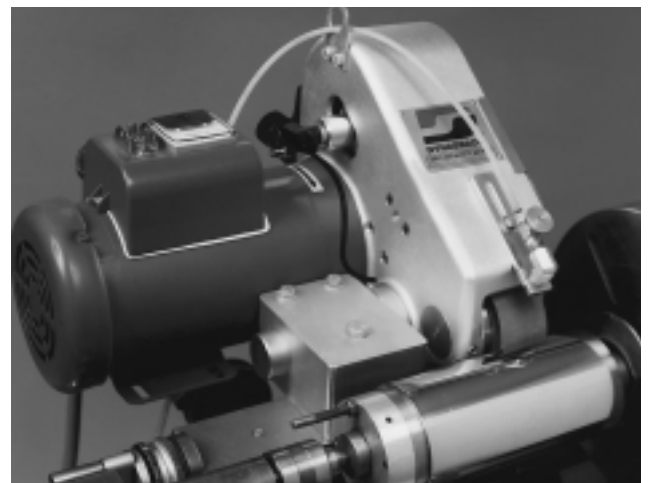

Model Number	Motor HP (W)	Motor RPM	Sound Level	Air Pressure PSI (Bars)	Max. SFPM (SMPM)	Voltage	Phase	Frequency	Weight Pound (kg)	Length Inch (mm)	Height Inch (mm)
64991	2.0 (1,491)	3,450	81 dB(A)	90 (6.2)	4,500 (1,367)	230	1	60 Hz	89 (40)	16 (406)	13-1/2 (343)
64993	2.0 (1,491)	2,850	81 dB(A)	90 (6.2)	4,500 (1,367)	230	1	50 Hz	89 (40)	16 (406)	13-1/2 (343)
65014	2.0 (1,491)	3,450	81 dB(A)	N/A	4,500 (1,367)	230	1	60 Hz	89 (40)	16 (406)	13-1/2 (343)
65016	2.0 (1,491)	2,850	81 dB(A)	N/A	4,500 (1,367)	230	1	50 Hz	89 (40)	16 (406)	13-1/2 (343)

Additional Specifications: Air Inlet Thread 1/4" NPT

Air-Powered Tool Post Grinder for 1-1/2" (38 mm) Wide x 24" (610 mm) Long Belts

Lightweight - Only 19 lbs. (8.6 kg)!

MODEL 66402

- For use on metal, glass, stone, rubber, ceramic, carbide composites and other hard to grind materials.
- Use with standard lathes. Simple tool holder mounting. Holds close tolerances.
- Rigid stainless steel and aluminum alloy machine construction.
- Surface finishes of 2-3 RA obtainable using micron-grade abrasive belts.
- Reduce surface finish on materials prior to a superfinishing process.
- In-line belt tracking prevents uneven belt stretching as found on conventional belt tracking arrangements.
- Fingertip controls for both motor on/off and adjustable air-belt tensioning.
- Cutaway housing design allows working into workpiece shoulders from right to left.
- 66430 Plain-Faced Contact Wheel 1-1/2" (38 mm) wide x 4" (102 mm) diameter is 70 durometer with other densities and styles available.
- 66425 Vacuum Scoop allows hookup to any vacuum system.

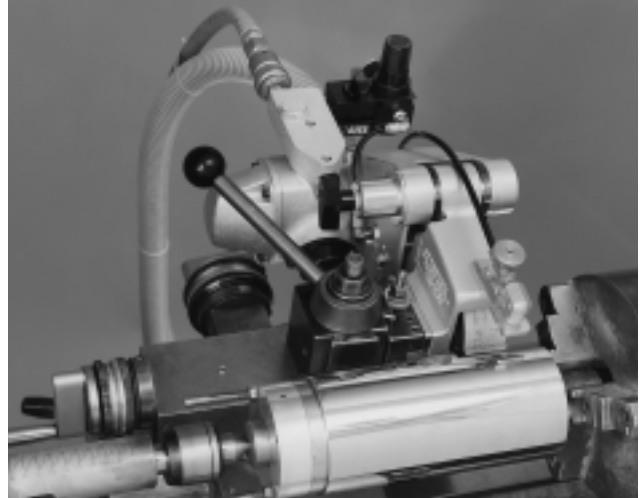

Model Number	Motor HP (W)	Motor RPM	Sound Level	Maximum Air Flow CFM/SCFM (LPM)	Maximum SFPM (SMPM)	Air Pressure PSI (Bars)	Weight Pound (kg)	Length Inch (mm)	Height Inch (mm)
66402	1.86 (1,387)	7,200	84 dB(A)	9/66 (1,869)	4,700 (1,428)*	90 (6.2)	19 (8.6)	15 (381)	10 (254)

Additional Specifications: Air Inlet Thread 3/8" NPT • Hose Size 1/2" (13 mm)

* At Maximum Load

Optional Accessories

Contact Wheels and Accessories for Model 66402

Contact Wheel Assembly Parts (Sold separately)

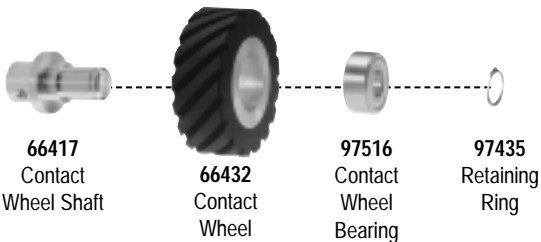

Precision Tool Post Grinder Contact Wheels

Part Number	Diameter Inch (mm)	Width Inch (mm)	Face Material
66429	4" (102)	1-1/2" (38)	50 Duro Plain Neoprene
66430	4" (102)	1-1/2" (38)	70 Duro Plain Neoprene
66431	4" (102)	1-1/2" (38)	90 Duro Plain Neoprene
66432	4" (102)	1-1/2" (38)	70 Duro Serrated Neoprene
66433	4" (102)	1-1/2" (38)	90 Duro Serrated Neoprene



Accessories for Model 66402

66439 Mount

- Allows offset tool installation for "facing" passes.



Contact Wheels and Accessories for Models 64991, 64993, 65014 and 65016

Precision Tool Post Grinder Contact Wheels

Part Number	Diameter Inch (mm)	Width Inch (mm)	Face Material
65237	4 (102)	2 (51)	70 Duro Rubber
65338*	4 (102)	2 (51)	90 Duro Rubber
65339	4 (102)	2 (51)	50 Duro Rubber
65340	4 (102)	2 (51)	Steel

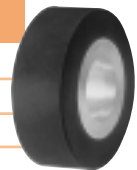

* Standard on machine. All include 2 ea. 97502 Bearings.

65415 Slack Belt Attachment



- 2" (51 mm) x 36" (915 mm)
- Specialized contact arm assembly allows slack polishing of workpieces up to 14" (356 mm) diameter.

Accessories for Models 65750-65753

66643 Slack Belt Attachment



- 2" (51 mm) x 48" (122 cm)
- Specialized contact arm assembly allows slack polishing of workpieces up to 20" (508 mm) diameter.

Portable Vacuum System

10-Gallon (37.8 l) System – One-to-two Tool Operation



Shown with standard and optional accessories.

- A** 64601 Filter Bag: Package of 5, for 64600 system (*included*).
- B** 64602 Filter Element: 1-micron filter. Clean with water and reuse (*included*).
- C** 64603 Hose Assembly: Connects air tools to vacuum. Includes 1/4" (6 mm) air hose and 1-1/4" (32 mm) x 16' (5 m) vacuum hose, all in one (*included*).
- D** 64604 T Connector: Used to convert air line system to allow multi-tool operation (*optional*).
- E** 64607 Inlet Connector: Used to connect Y-connector to vacuum port (*optional*).
- F** 64608 Y Connector: Used to connect two hose assemblies to one vacuum port on the system.
- G** 95800 Hose Cuff: Connects hose assembly to tool with 1-1/4" (32 mm) vacuum port (*optional*).

MODEL 64600

- Ideal for use with all Dynabrade central vacuum tool models.
- Portable Vacuum systems and hose accessories are compatible with other brands air and electric tools.

Noise-Free Environment

- Exceeds OSHA requirements for noise level output, 58 dB(A).

Efficient Operation Conserves Electricity

- Auto start/stop: Controls vacuum motor start/stop on demand from hand tool lever.

Multi-Tool Operation

- Designed to operate up to four air tools and one electric tool independently or simultaneously for maximum use of system.

Anti-Static Operation

- Complete vacuum system fully grounded, suction hose and connectors are manufactured from conductive materials to eliminate static electric build up.

Powerful Vacuum

- Provides high air flow, 120 CFM (3,398 LPM), and vacuum, 90" (229 cm) of water lift, for a wide range of cleaning applications.

1 Micron Filter

- Efficient, cleanable and replaceable air filter element.
- 64609 H.E.P.A. Filter Kit (.3-micron capacity) is available.

Adjustable Vacuum Suction

- Rheostat motor control allows for variable vacuum suction.

Cyclonic Effect

- Offset inlet fitting provides even filling of canister and disperses debris away from filter element.

Optional Vacuum Accessories

Accessories for Models 64991, 64993, 65014, 65016, and 66402

95800 Hose Cuff

1-1/4" (32 mm) x 1-1/4" (32 mm) Diameter

- Has internal thread for 1-1/4" (32 mm) dia. hose.
- Mounts to machine's vacuum scoop.
- One cuff (not installed). Mounts directly to machine.



54205 Exhaust Hose

1-1/4" (32mm) Diameter



- By-the-foot (no cuffs); specify up to 50 feet (15 meters).

Accessories for Models 64991, 64993, 65014 and 65016

65341 Belt Guard



Optional belt guard with vac port available.

Accessories for Models 65750 - 65753

66633 Belt Guard



Optional belt guard with vac port available.

95698 Hose Cuff

2" (51 mm) x 2-1/2" (64 mm) Diameter

- Has internal thread for 2-1/2" (64 mm) dia. hose.
- Mounts to machine's vacuum port.
- One cuff (not installed).



Tool Post Grinders

For Inner and Outer Diameter Grinding, Surface Preparation and Finishing



Abrasives

For Models 65750, 65751, 65752 and 65753

Ceramic Coated Aluminum Oxide Belts

Grit	60	80	120
Part No.	90393	90394	90395

Unit = 50 belts

Flexible Diamond Abrasive Belts

Microns	125	74	40	20	10
Part No.	91375	91376	91377	91378	91379

Minimum order: 1 belt. Immediate delivery on small quantity orders, larger quantities allow approximately 3 weeks delivery. Diamond belts are not combinable with other abrasives.

For Models 64991, 64993, 65014 and 65016

Ceramic Coated Aluminum Oxide Belts

Grit	36	60	80
Part No.	90382	90383	90384

Aluminum Oxide Microfinishing Film

Microns	80	60	40	30	15	9
Part No.	91369	91370	91371	91372	91373	91374

Unit = 50 belts

Flexible Diamond Abrasive Belts

Microns	125	74	40	20	10
Part No.	91361	91363	91364	91365	91366

Diamond belt minimum order: 1 belt (delivery: approximately 3 weeks). Diamond belts are not combinable with other abrasives.

For Model 66402

Ceramic Coated Aluminum Oxide Belts

Grit	120	80	60
Part No.	91634	91633	91632

Aluminum Oxide Microfinishing Film

Microns	80	60	40	30	15	9
Part No.	91335	91336	91337	91338	91339	91340

Unit = 50 belts

Flexible Diamond Abrasive Belts

Microns	125	74	40	20	10
Part No.	91344	91345	91346	91347	91348

Diamond belt minimum order: 1 belt (delivery: approximately 3 weeks). Diamond belts are not combinable with other abrasives.

For Other Dynabrade Tools and Related Accessories, Visit www.dynabrade.com



DISTRIBUTED BY:

DYNABRADE, INC.

8989 Sheridan Drive • Clarence, New York 14031-1490 • Phone: (716) 631-0100 • Fax: 716-631-2073
US Consumers Call Toll Free: 1-800-828-7333

DYNABRADE INTERNATIONAL

8989 Sheridan Drive • Clarence, New York 14031-1490 • Phone: (716) 631-0100 • Fax: 716-631-2524
Canadian Consumers Call Toll Free: 1-800-344-1488

DYNABRADE EUROPE S.à.r.l.

Zone Artisanale • L-5485 Wormeldange—Haut, Luxembourg • Telephone: 352 76 84 94 1 • Fax: 352 76 84 95 1

Try Our New U.S. Consumer Toll Free Number: 1-888 DYNABRADE